

No.6150 : ABRASIVE BLASTING HELMET « PANO »

This sandblasting helmet is lightweight and comfortable, it is really suitable for any type of sand blasting work. The panoramic blasting helmet is designed with a large viewing window. This window is an important asset when the movements of the sandblasting operator are limited.



ADVANTAGES

The « **PANO** » sandblasting helmet is equipped with a robust air pressure regulator, a visual air flow indicator and a comfortable nylon cape.

Two very large windows and a protective screen protects the vision of the sandblasting operator and protects from dust and abrasive jets.

An inner window fits securely into a molded rubber seal. An acetate glass protects the inner glass from glazing and can be quickly replaced.

Its unique design ensures continuous air circulation to the visor to prevent fogging.

A large screen of wire mesh Protects from jets of abrasives.

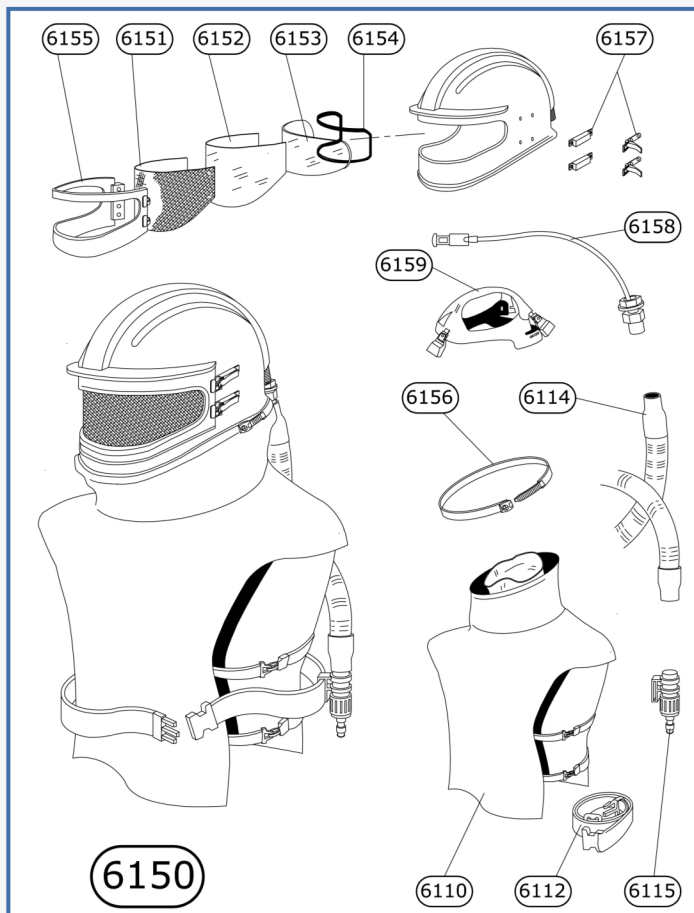

- A sturdy shell ensures operator safety and a long lifetime of the helmet.
- The operator is protected from abrasive bounces by a wide and strong visor.
- The passage of the abrasive between the lenses is prevented by seal.
- Double locking of the window.
- The cape is attached via adjustable collar.

The disposable lenses

On the « **PANO** » helmet, A flexible acetate window is used as a disposable lens and is protected by a stainless steel mesh. The two large windows and the metal screen provides high visibility and protection.